

TOTAL EXTENT (1.14ac) : 4613 M²

ROAD AREA : 974 M²

PARK AREA : 345 M²

N^o OF PLOTS : 14

NOTE :-

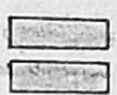
1. SPLAY 3.0 x 3.0M
2. MEASUREMENTS INDICATED ARE EXCLUDING SPLAY DIMENSIONS.
3.  ROAD AREA } WERE ALREADY HANDED OVER
PARK AREA } TO LOCAL BODY VIDE GIFT DEED
DOC. N^o 35/99 DATED 23.7.99

CONDITION :-

1. THE LEVEL OF SITE IS TO BE RAISED ON PAR WITH THE EXISTING ROAD LEVEL
2. POWER LINE IS TO BE SHIFTED BEFORE IMPLEMENTATION OF THE PROPOSAL.
3. ~~CONCURRENCE FROM PUBLIC WORKS DEPARTMENT IS TO BE OBTAINED FOR NOT AFFECTING THE CHANNEL BY THE PROPOSED LAYOUT.~~

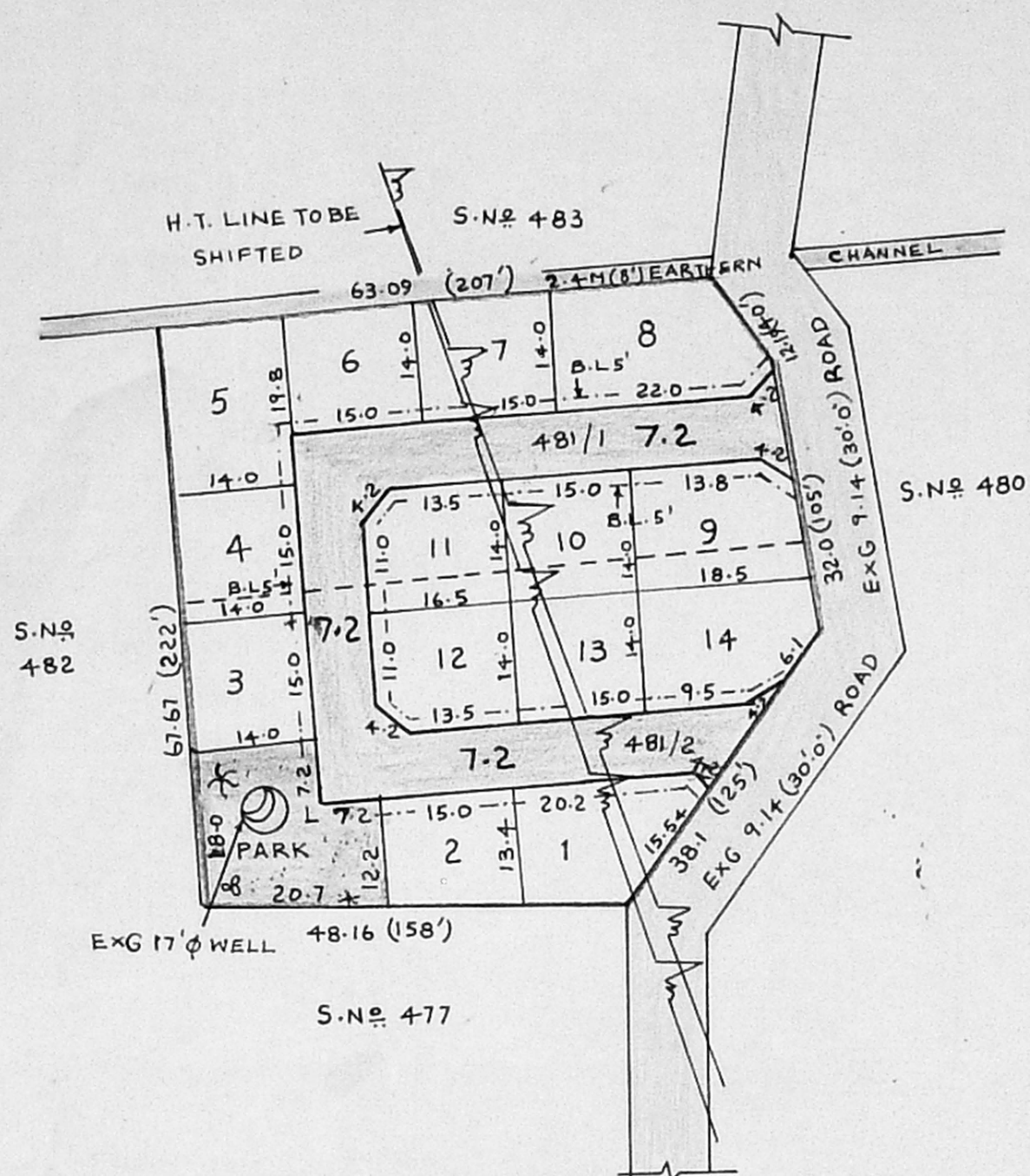

Sasikala
TRACED BY

[Signature]
P.A-I (V.K.)

[Signature]
A.P (R.R.G)

[Signature]
D.P (M.S) 1/199.

AMBATTUR MUNICIPALITY
TAMIL NADU HOUSING BOARD
LAYOUT OF HOUSE SITES IN S.No 481/1 & 481/2
OF AMBATTUR VILLAGE.
SCALE : (66 FEET TO AN INCH) 1:800.

P.P.D
L.O (T.N.H.B) N^o 6/99

APPROVED

VIDE LETTER N^o : L2/13609/99
DATED : -10-99

5/5 *[Signature]*
FOR MEMBER SECRETARY
CHENNAI METROPOLITAN
DEVELOPMENT AUTHORITY

